

TIMKEN**The Timken Company**

4500 Mt Pleasant St. NW

N. Canton, OH 44720

Phone: (234) 262-3000**E-Mail:** CustomerCAD@timken.com • **Web site:** www.timken.com**Part Number 7306 BTN1, Timken® Single Row Angular Contact Ball Bearings (7200, 7300)**

Timken® angular contact ball bearings are designed for combination radial and axial loading. Single-row bearings have high thrust capacity in one direction. Some single-row bearings are specifically designed for duplex mounting in sets for maximum performance.

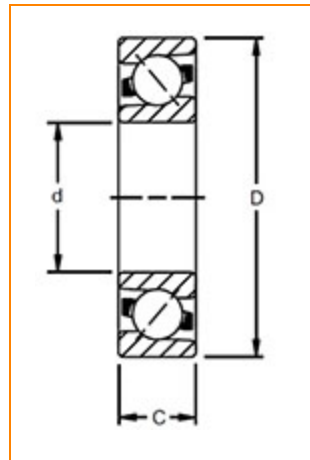

[Dimensions](#) | [Basic Load Ratings](#) | [Factors](#) | [Specifications](#) | [Abutment and Fillet Dimensions](#)

Dimensions

d - Bore	30.00 mm 1.1811 in
D - Outer Diameter	72.00 mm 2.8346 in
Bearing Width	19.00 mm 0.7480 in
Contact Angle	40 °

Basic Load Ratings

C0 - Static Radial Rating	19300 N 4338 lbf
----------------------------------	---------------------



21000 N

C1 ISO - Dynamic Radial Rating 51000 N
6968 lbf

Factors

Limiting Speed (Grease) 9600 rpm
Limiting Speed (Oil) 13000 rpm

Specifications

Ball Type STEEL
Cage Type Molded
Cage Material Polyamide
Bearing Weight 0.35 Kg
0.772 lb
Design Units METRIC
R - Inner Ring "Touch" Radius 0.6
r - Outer Ring "Touch" Radius 0.6
Features Open

Abutment and Fillet Dimensions

R - Inner Ring "To Clear" Radius¹ 0.60 mm
0.024 in
r - Outer Ring "To Clear" Radius² 0.60 mm
0.024 in
da - Inner Ring Backing Diameter 37.0 mm
1.457 in
Da - Outer Ring Backing Diameter 65.00 mm
2.5590 in

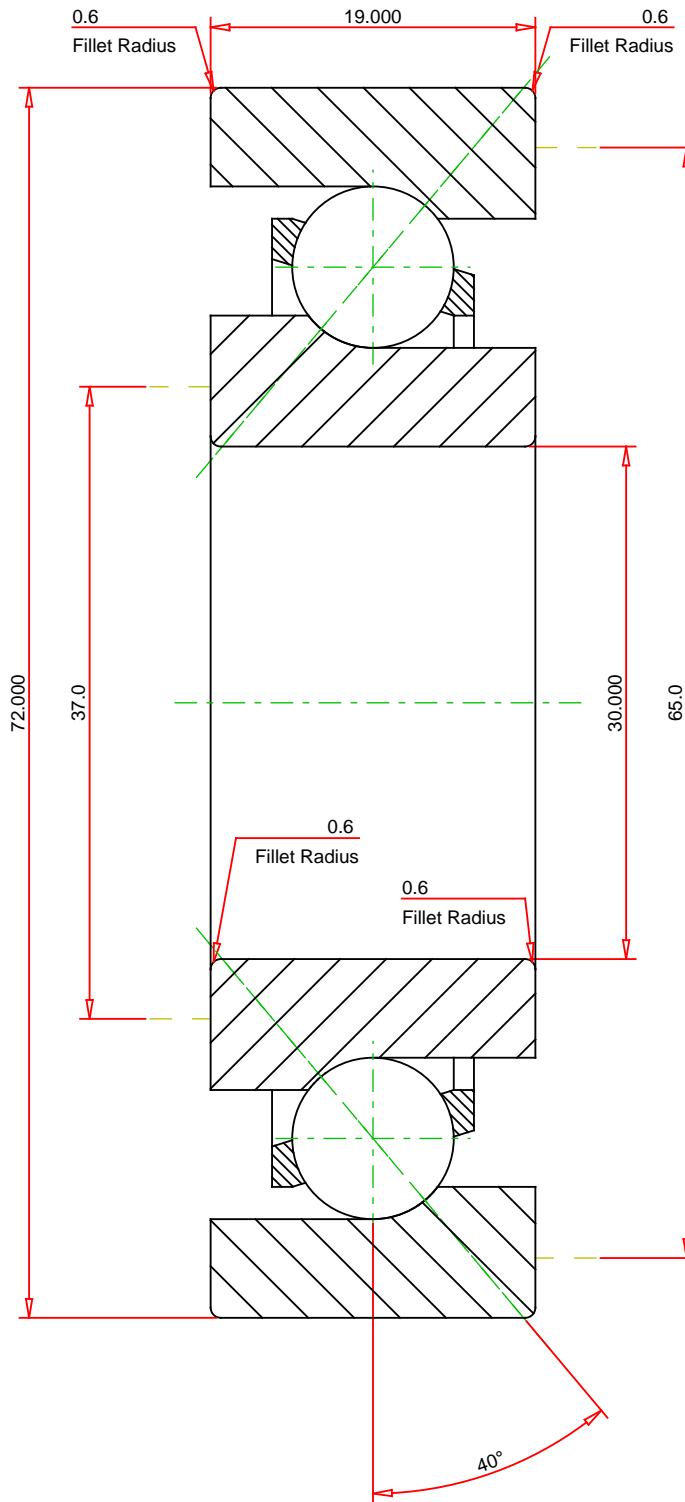

METRIC UNITS

Number of Balls Per Row	11
Bearing Weight	0.350 kg

TIMKEN™

THE TIMKEN COMPANY
NORTH CANTON, OHIO USA

7306 BTN1
Timken® Single Row Angular Contact Ball Bearings
(7200, 7300)

Dynamic Radial Rating	31000	N
Static Radial Rating	19300	N

Every reasonable effort has been made to ensure the accuracy of the information contained in this writing, but no liability is accepted for errors, omissions or for any other reason.

FOR DISCUSSION ONLY